

ARLINGTON II

www.CRAMERCUSTOMHOMES.COM



First Floor	982 sq ft
Second Floor	1101 sq ft
Total	2083 sq ft

Basement 982 sq ft
 Garage 462 sq ft
 (3 car garage and fireplace options available)

FIRST FLOOR

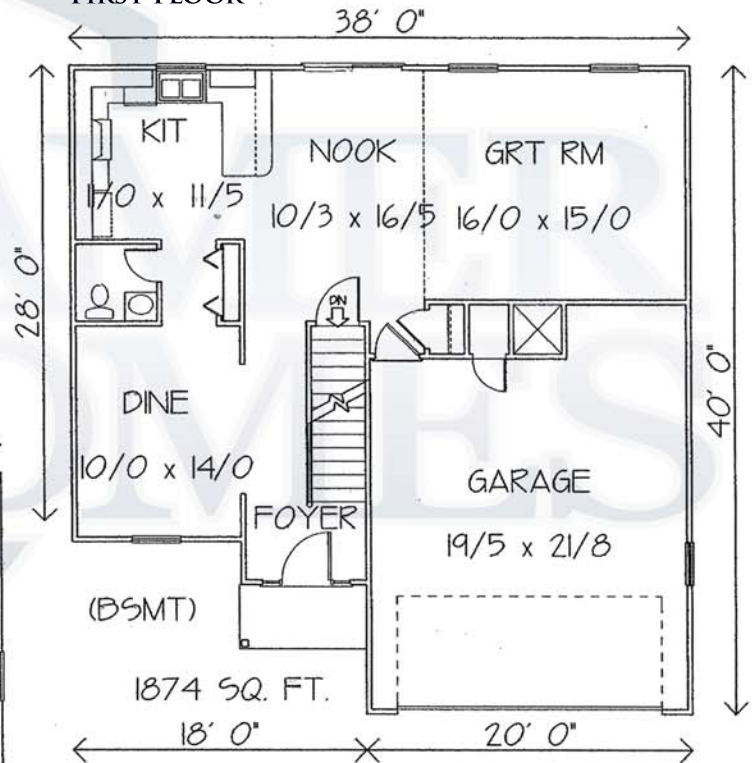

SECOND FLOOR

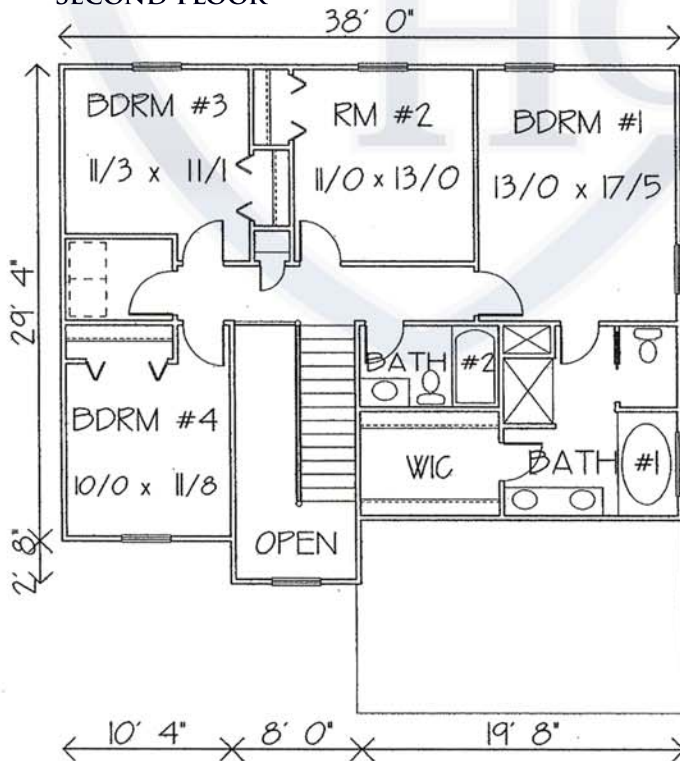

Mahomet, IL
 217-586-4732